

# LCC Series

## ▶ LCC-80

- Insensitive to outside light due to interference filter and modulated laser light
- Visible laser spot (red light 670 nm)
- Parameterisable via RS232
- RS232 interface and Windows® user interface
- Automatic adjustment to product
- Extern-trigger function
- Counting of imbricated copies at high conveying speed (100 000 copies/h)
- For use in overhead conveyor systems in combination with two initiators (position window)
- For use in compensating stackers



## Design

### Product name:

**LCC-80**  
(incl. Windows® software SI-LCC-Scope)

### Accessories:

**TB-80** (attachment optics, cf. page 4)  
**INI-18** (approach switch, cf. page 4)

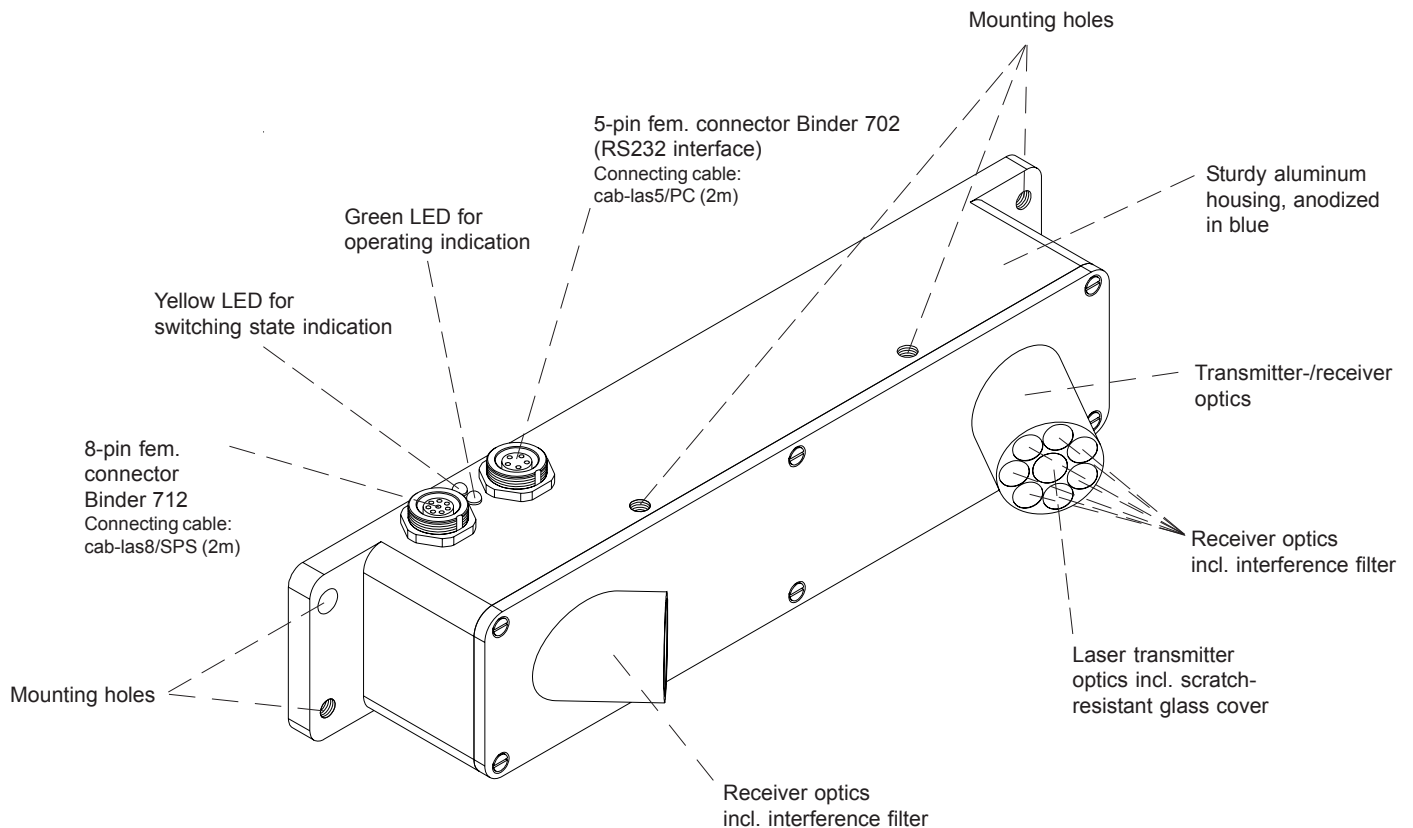



**Technical Data**

Model	LCC-80
Laser	Semi-conductor laser, 670 nm, AC operation, 1 mW max. opt. power, laser class 2 acc. to DIN EN 60825. The use of this laser sensor therefore requires no additional protective measures.
Optical filter	Red light filter RG630 and interference filter
Digital output	pnp bright-switching/npn dark-switching or pnp dark-switching/npn bright-switching (OUT0 and OUT1), adjustable under Windows® on PC
Voltage supply	+24VDC (± 10%)
Sensitivity setting	adjustable under Windows® on PC
Laser power correction	adjustable under Windows® on PC
Current consumption	typ. 150 mA
Dead time	adjustable under Windows® on PC
Dead time mode	static or dynamic, adjustable under Windows® on PC
Enclosure rating	IP54
Operating temperature range	-20°C ... +50°C
Storage temperature range	-20°C ... +85°C
Housing material	Aluminum, anodized in blue
Housing dimensions	approx. 205 mm x 40 mm x 40 mm
Type of connector	8-pin female connector type Binder Series 712 5-pin female connector type Binder Series 702
EMC test acc. to	DIN EN 60947-5-2
Scan frequency	typ. 15 kHz (without averaging)
Switching state indication	Visualization by means of a yellow LED
Dynamic output (pulse lengthening)	adjustable under Windows® on PC
Max. switching current	100 mA, short-circuit protected
Interface	RS232, parameterizable under Windows®
Connecting cables	Connection to PC: cab-las5/PC (2m) Connection to PLC: cab-las8/SPS (2m)
Modulation frequency	typ. 100 kHz
Max. product stream	typ. 500 000 copies/h
Min. height of object	typ. 0.1 mm
Output polarity	Bright-/dark-switching, can be adjusted under Windows® on PC
Working range	typ. 60 mm ... 100 mm

Dimensions

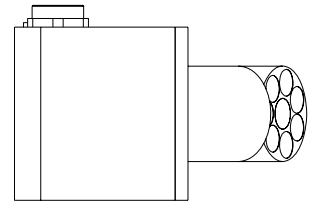
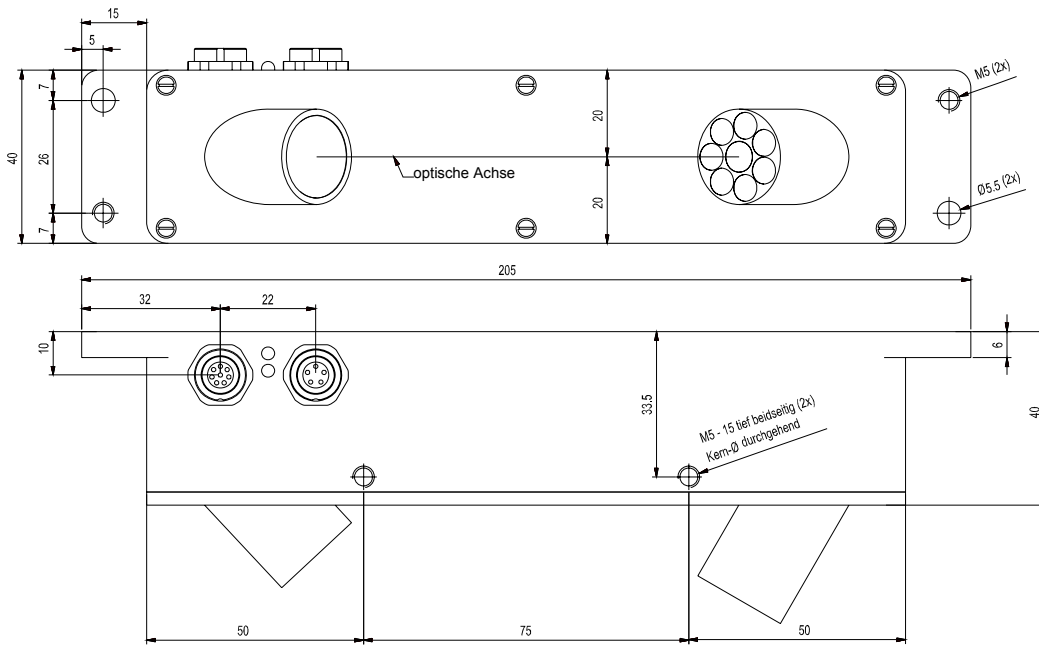

All dimensions in mm

Working Distance

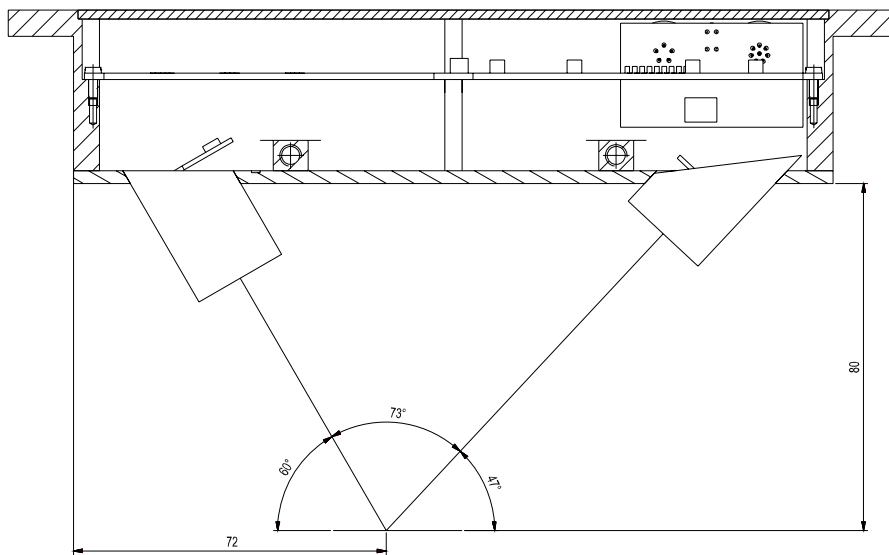

All dimensions in mm



### Approach switch INI-18

Model	INI-18
Switching distance	typ. 8.0 mm
Mounting	not flush mounted
Voltage supply	+10 ... +30 VDC
Max. load	200 mA
Max. switching frequency	typ. 500 Hz
Ambient temperature	-25°C ... +70°C
Enclosure rating	IP67
Switching state indication	via LED in the M12-connector
Housing material	Brass, nickel-plated
Type of connector	4-pin M12-connector



### Tube TB-80 (for transmitter-/receiver optics)

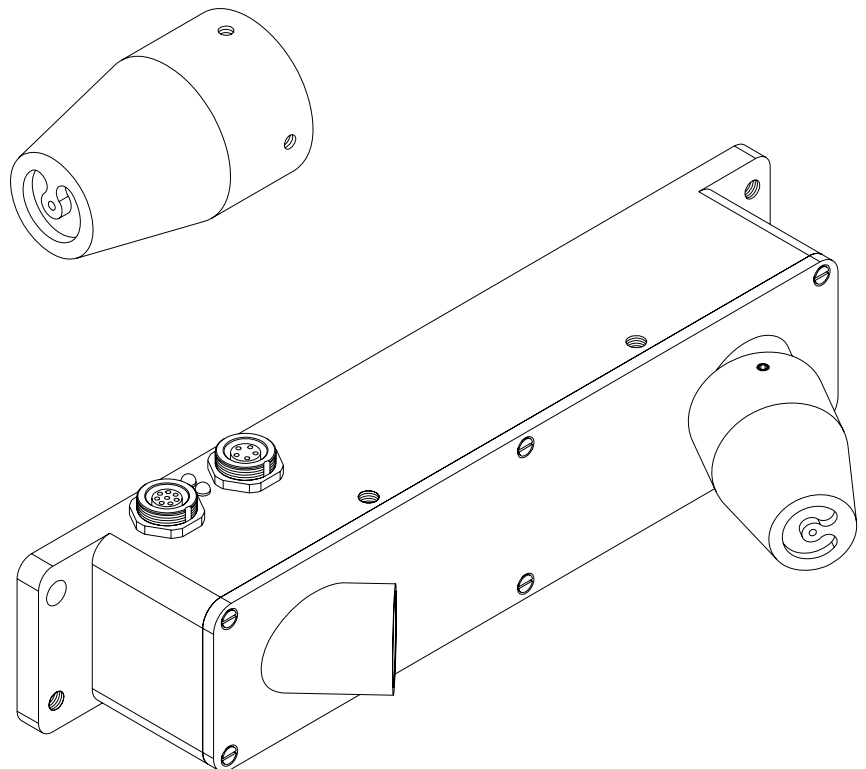
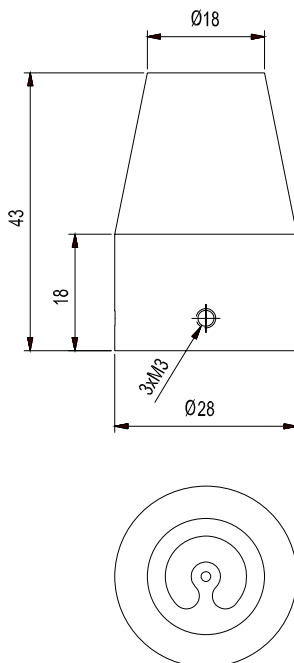

All dimensions in mm

**Connector Assignment**

**Connection to PLC:  
8-pin female connector Binder Series 712**

Pin No.	Color	Assignment
1	wht	GND (0V)
2	brn	+24VDC ( $\pm 10\%$ )
3	grn	IN0
4	yel	IN1
5	gry	OUT0
6	prnk	OUT1
7	blu	n.c.
8	red	n.c.

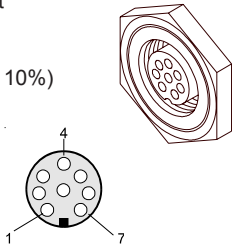

**Connection to PC:  
5-pin female connector Binder Series 702**

Pin No.	Assignment
1	GND (0V)
2	TX0
3	RX0
4	n.c.
5	n.c.

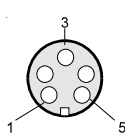
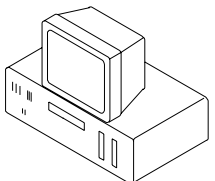
**Connecting Cables**

**Connecting cables:**

cab-las8/SPS Length: 2 m Outer jacket: PUR  
 cab-las5/PC Length: 2 m Outer jacket: PUR

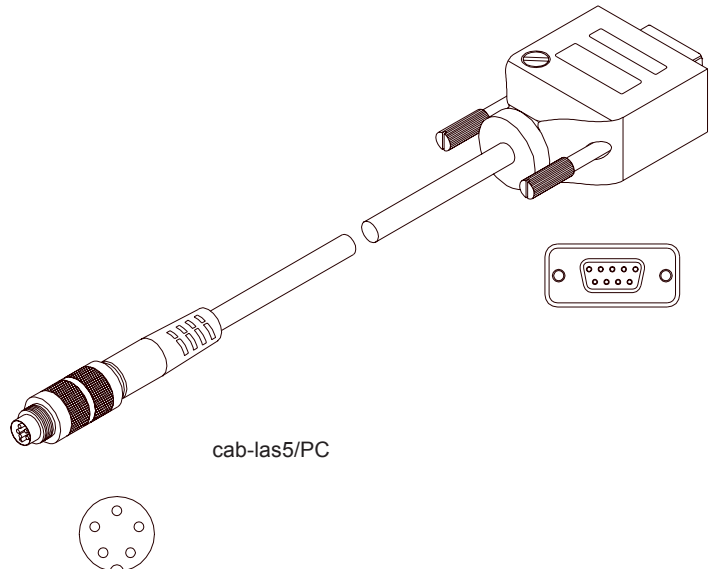
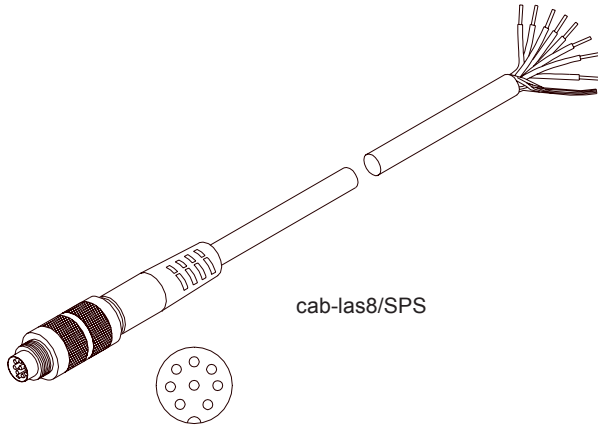

**Laser Warning**

The laser copy counters of LCC Series comply with laser class 2 according to EN 60825. The use of these laser transmitters therefore requires no additional protective measures.

The laser copy counters of LCC Series are supplied with a laser warning label.

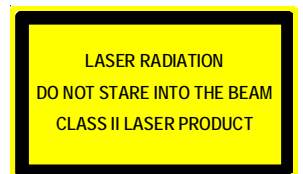



## Parameterization

### Windows® software SI-LCC-Scope V1.0:

The LCC-80 laser copy counter can be easily parameterised with the Windows® user interface. For this purpose the LCC-80 system is connected to the PC with the serial interface cable cab-las5/PC. When parameterisation is finished, the PC can be disconnected again.

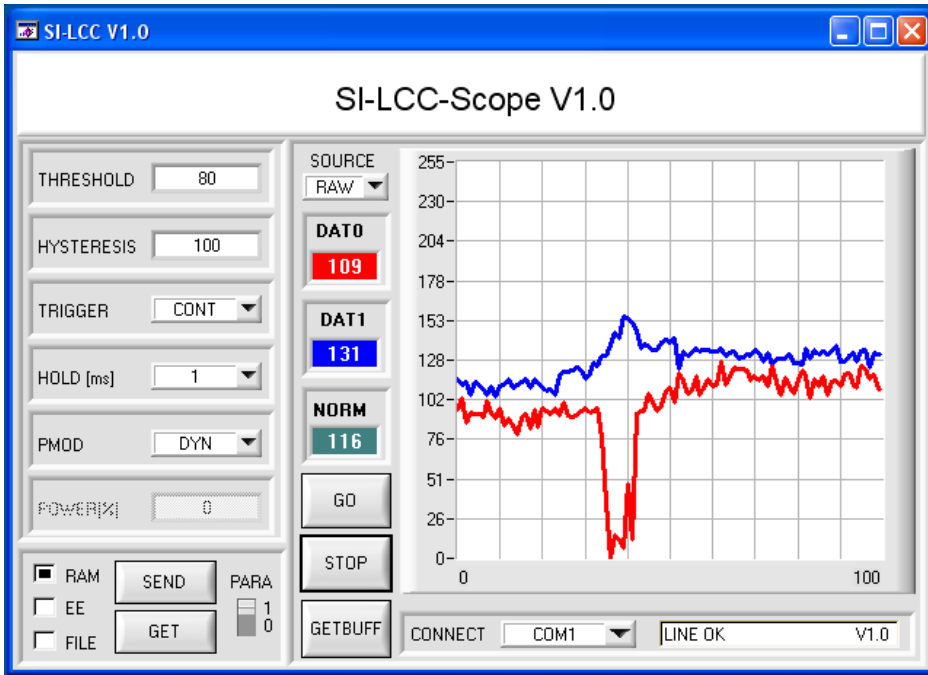

Windows® user interface



#### PMOD:

In this function field the operating mode of automatic power correction at the transmitter unit (laser) can be set.

**FIX:** In this operating mode the POWER function field is *enabled* for setting purposes. The laser transmission power is kept constant at the value set in the POWER function field.

**DYN:** In this operating mode the POWER function field is *disabled* for setting purposes. The laser transmission power is automatically and dynamically controlled in accordance with the amount of radiation that is diffusely reflected from the object. By using the intensities measured at the receiver, the automatic control circuit attempts to adjust the transmission power in such a way that the dynamic range is not exceeded.

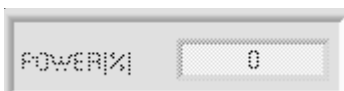

#### POWER[%]:

In this function field the intensity of the laser diode can be set (0% = Laser OFF, 100% = full laser diode intensity).



#### HOLD:

In this function field the pulse lengthening time [ms] (after detecting an edge) for OUT0 can be set.



#### PARA:

This changeover switch determines whether the parameters BACKLIM, REGCNT, AVERAGE, DEAD TIME MODE, and DEAD TIME are displayed or hidden.

1 = Hide parameters  
0 = Display parameters

Parameterization

THRESHOLD 80

**THRESHOLD:**

Input field for the lower threshold. The sensor sensitivity increases with a higher THRESHOLD value.

HYSTERESIS 100

**HYSTERESIS:**

Input field for the desired hysteresis. For detecting an edge, the NORM VALUE of the two RAW SIGNALS must drop below a certain THRESHOLD during measurement to initiate a counting event.

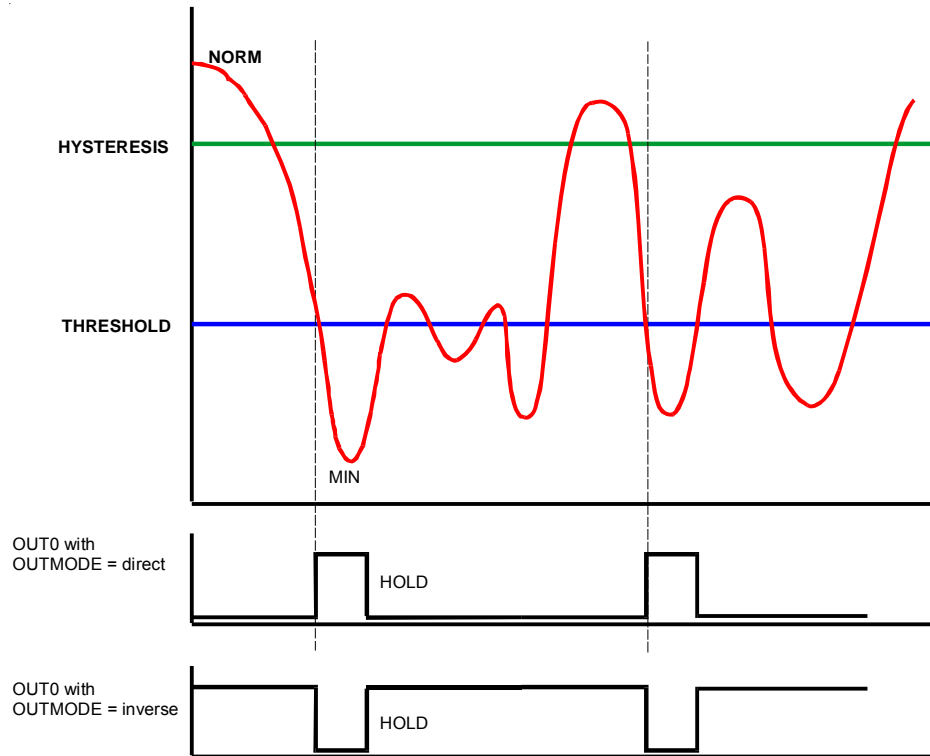

When the sensor detects an edge (NORM VALUE drops below THRESHOLD), a search for the minimum NORM VALUE is performed until the end of the DEAD TIME (TRIGGER=CONT) or the ACTIVE TIME (TRIGGER=EXT) and during HOLD. This minimum value is stored in a 16-value JUMP-BUFFER that can be read out with the GETBUFF software button.

After the value has dropped below a THRESHOLD, the NORM VALUE must again lie above the value set under HYSERESIS, to allow renewed edge detection. This is an additional safety feature to suppress multiple counting around the THRESHOLD.

Parameterization

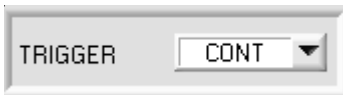

TRIGGER = CONT:  
Measurement is performed continuously.

TRIGGER = EXT:  
An ACTIVE WINDOW is set for the sensor by the two inputs IN0 and IN1. The window is opened with a positive signal edge at IN0, and is closed again with a positive signal edge at IN1. The sensor measures during its ACTIVE TIME, and if it detects an edge, an output counting pulse is provided immediately after the ACTIVE WINDOW is closed.

Only one edge can be detected during the ACTIVE TIME. Output OUT1 serves for monitoring the active time. For renewed edge detection, the two inputs must detect a negative signal edge.

Application example:  
Objects that are transported by means of mechanical or other kinds of grippers. The trigger signals (+24V) can be supplied to the sensor by means of inductive sensor or light barriers, etc. The advantage of this method of measuring is that the sensor is completely independent of the speed.

TRIGGER = ADJ EXT:  
For future measurements with an active window (TRIGGER = EXT), this mode makes it easier for the user to adjust the two initiators for the active window; see picture below.

For operating the sensor with an active window, two initiators must inform the sensor about the active time. As described above, the active window is opened with a positive signal edge at input IN0 and is closed again with a positive signal edge at input IN1.

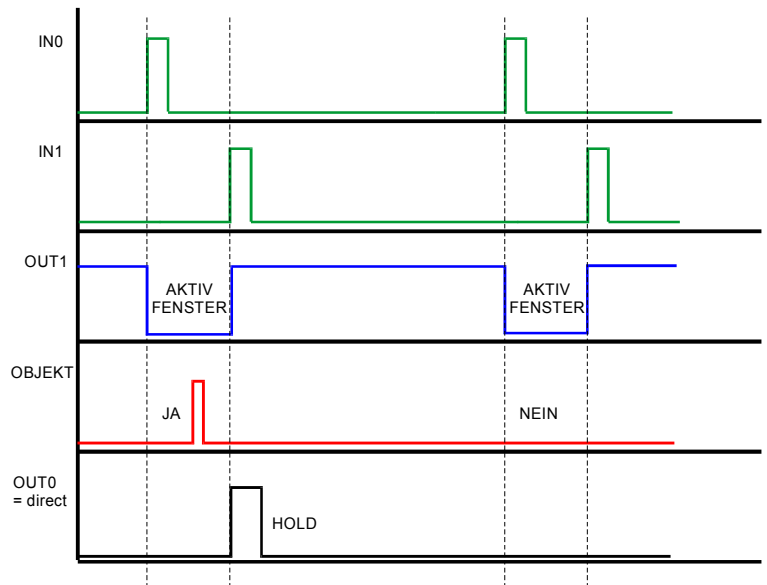

The TRIGGER = ADJ EXT mode was introduced to allow improved sensor adjustment. When this mode is selected, the sensor records the time from one positive signal edge at IN0 to the next positive signal edge at IN0 and evaluates this time as 100%. This is shown in the graphic display, when the GO button is pressed and SOURCE = EXT is selected. When the GO button is pressed, the data are automatically updated after one second. The value of 100 on the x-axis corresponds with 100% (time from IN0 to IN0).

The red graph visualised the length of the active window in percent of the time between IN0 and IN0. The blue graph visualises the appearance of an edge in percent of the time between IN0 and IN0.

It can be seen in the example shown here that the active window is equal to 59% of the time from IN0 to IN0, i.e. the sensor detected a positive signal edge at IN1 after 59% of IN0 to IN0, which closed the active window. The edge was detected at 30% of IN0 to IN0. These two values are also shown in the EDGE [%] and WIN [%] display fields.

In practice, the active window should be open approx. 60% of IN0 to IN0. The edge should lie in the middle of the active window (30%).

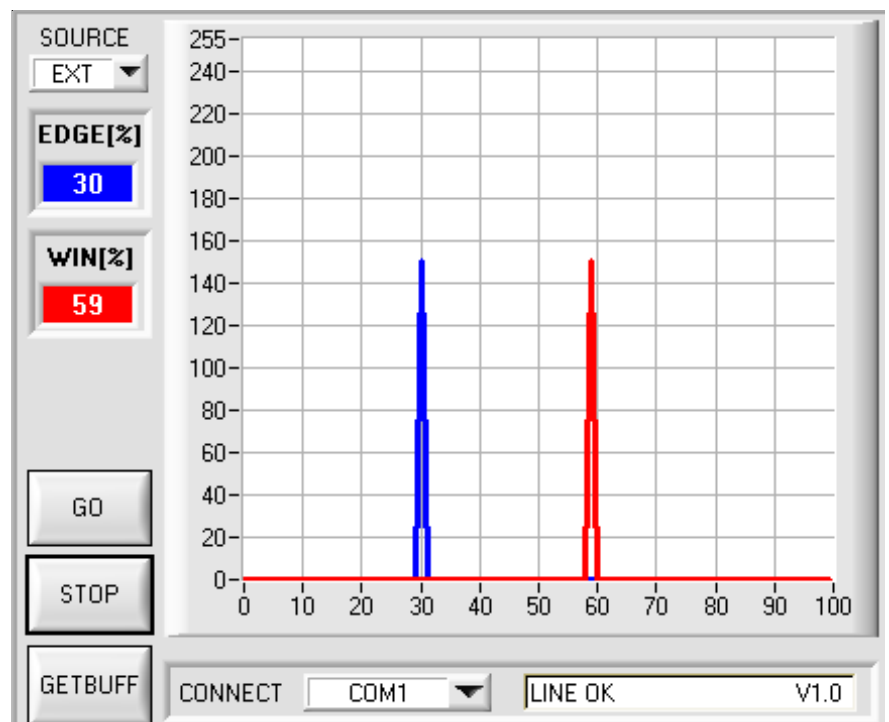



 Parameterization

 
**BACKLIM:**

In this edit-box an intensity limit can be set. If the intensity that arrives at the receiver unit DAT0 (display window in the user interface) drops below this limit, no evaluation will be performed.

 
**REGCNT:**

This edit-box serves for setting after how many loop runs dynamic laser diode correction should be performed.

Example: SCAN frequency 15 kHz is equal to 66.6  $\mu$ s  
REGCNT = 75

Calculation: 66.6  $\mu$ s \* 75 = 5 ms

Result: Dynamic correction is performed every 5ms

Explanation: Flatly rising magazines are detected, because dynamic correction is not performed with every loop run, and the jump is automatically compensated, so to speak.

The EDIT-BOX REGCNT is *enabled* when PMOD = DYN.

When PMOD = FIX the EDIT-BOX REGCNT is *disabled* as no laser transmitting power correction is done.

 
**AVERAGE:**

This edit-box serves for setting averaging through NORM.

The minimum value for averaging is 1.

The maximum value for averaging is 128.

An average of 1 is sufficient for most applications.

Please note:

If AVERAGE = 1, the internal scan frequency = 15 kHz.

If AVERAGE = 2, the internal scan frequency = 7.5 kHz.

If AVERAGE = 4, the internal scan frequency = 3.75 kHz.

etc.

 
**OUTMODE:**

This edit-box determines how the output impulse should be output at OUT0:

Direct:

When a counting event occurs, output OUT0 changes from LOW (0V) to HIGH (+24V), until HOLD is over.

Inverse:

When a counting event occurs, output OUT0 changes from HIGH (+24V) to LOW (0V), until HOLD is over.

 
**DEAD TIME MODE (DT MODE):**

This function field shows the DEAD TIME MODE that is used.

DT MODE = FIX:

A fixed dead time is used. The dead time is set in milliseconds under DEAD TIME [ms].

DT MODE = DYN:

A dynamic dead time is used. The dead time is set in percent under DEAD TIME [%].

The time between two edges is valuated as 100%. The dead time is calculated in accordance with the percent value that is set under DEAD TIME [%]. The dead time can be measured through monitor output OUT1 (low-active).

If TRIGGER = EXT is selected, the sensor operates with an ACTIVE TIME. In this case the input fields DEAD TIME MODE and DEAD TIME [...] are disabled. The active time can be measured through monitor output OUT1 (low-active).

**TYPE:**

The data that are to be displayed in the graphic window (RAW, NORM) can be selected in this function field.

**RAW:**

The raw data DAT0 and DAT1 are visualised in the graphic window. In addition these values are displayed in the two numerical value output fields DAT0 and DAT1.

**NORM:**

The NORM calculated from DAT0 and DAT1 is displayed in the graphic window. In addition this value is displayed in the numerical value output field NORM.

**GETBUFF:**

When the GETBUFF button is clicked, the last minimum values of the NORM SIGNAL after edge detection are displayed. In addition, the THRESHOLD which the values of the NORM SIGNAL must remain under is visualized in the graphical display window.

Upon detection of an edge the sensor starts to search the minimum value of the NORM SIGNAL during the DEAD TIME and HOLD. This value is then stored in a 16-value ring buffer. Based on these VALUES, the optimum THRESHOLD for the current product run can then be set.

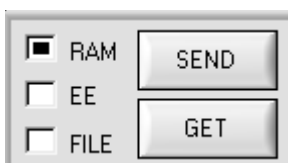
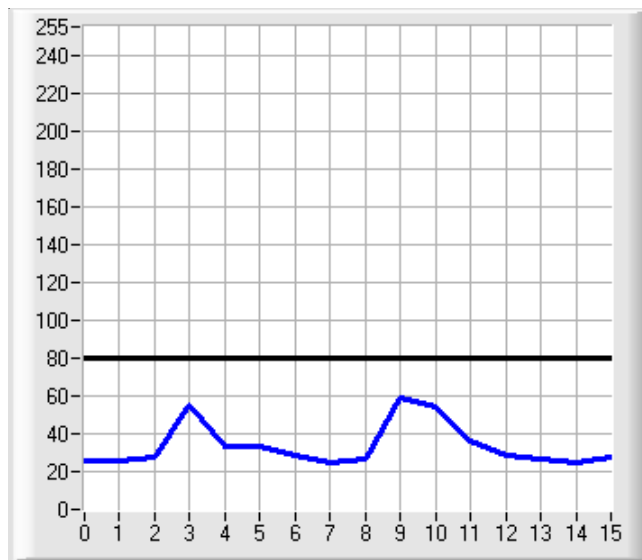

This group of function keys serves for parameter exchange between the PC and the control unit through the serial RS232 interface.

**SEND:**

When the SEND button is clicked, all the currently set parameters are transferred between the PC and the control unit or to an output file. The target of the respective parameter transfer is determined by the selected button (RAM, EE, or FILE).

**GET:**

The current setting values can be called up from the control unit by clicking on the GET button. The source of data exchange is determined by the selected button (RAM, EE, or FILE).

**RAM:**

The current parameters are written to the RAM memory of the control unit, or they are read from the RAM, i.e. these parameters are lost again when the voltage is switched off at the control unit.

**EE:**

The current parameters are written to the non-volatile memory of the EEPROM in the control unit, or they are read from the EEPROM, i.e. the parameters in the internal EEPROM are stored when the voltage is switched off.

**FILE:**

A click on this selection button opens an info field with the file name of the current parameter file.

**Application Example****Copy counting at compensating stackers**

The LCC-80 or LCC-90 laser copy counter even detects high-gloss copies of different thickness with highest reliability. Because of the special evaluation method, different conveying speeds have no influence on the counting result.





Mounting

Mounting the two initiators at overhead conveyors

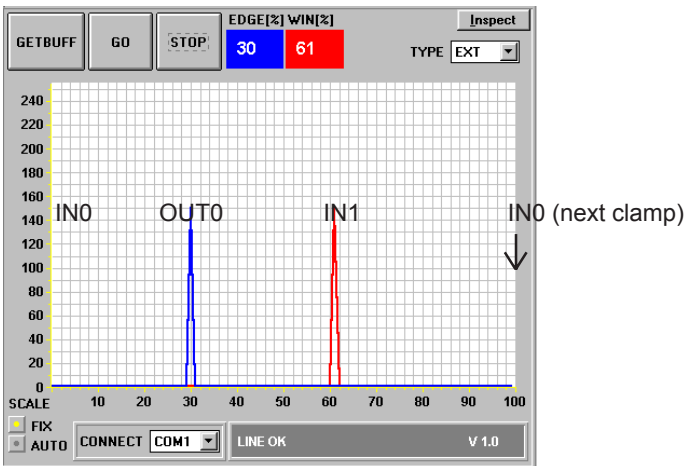
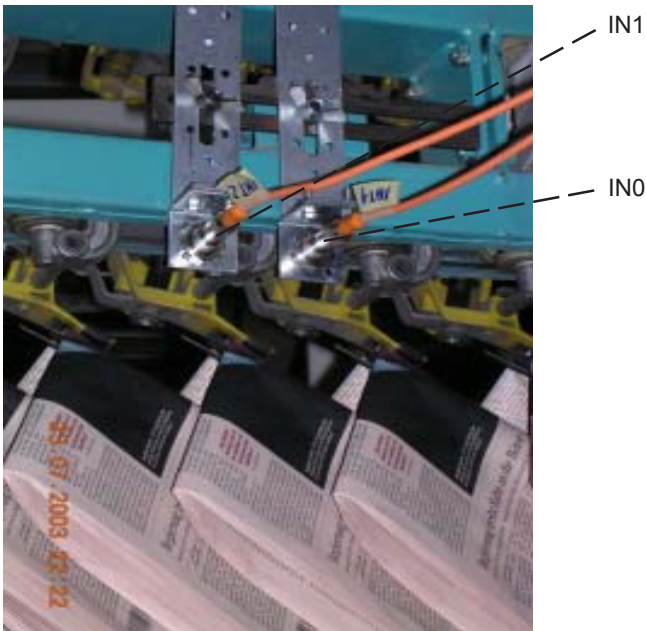
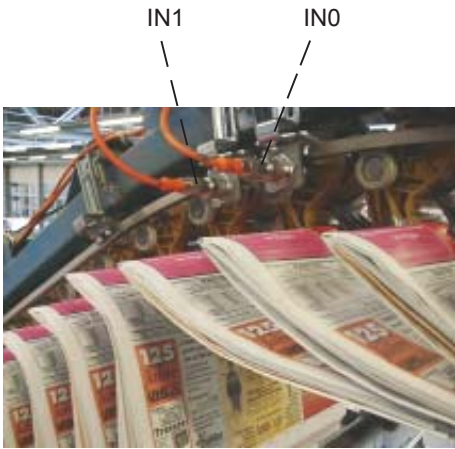

The initiators are mounted in such a way that the position of the two sensors can be freely chosen. Care must be taken to ensure that both sensor 1 and sensor 2 detect every clamp.

Furthermore, the distance of the two sensors with respect to each other must be chosen in such a way that, with respect to time, the output signal of the laser sensor lies approximately in the middle of trigger signals IN0 and IN1.

The ADJEXT mode that can be activated in the SI-LCC V1.0 Windows® software, serves as a setting aid for this; the chart indicates the positions of IN0, OUT0, and IN1 (initiator 1, laser copy counter, initiator 2). Based on the assumption that IN0 to IN0 = 100%, IN0 to IN1 should be approx. 60%, whereas IN0 to OUT0 should lie at approx. 30%.

